

How to trim your lampshade

We have a range of readymade trimmings that can be used to finish your lampshade. Alternatively why not make your own to match your fabric.

Make your own trimmings

Make your own lampshade trimmings with the Bias Tape Maker. Create customized single fold bias tape with the push of a button.

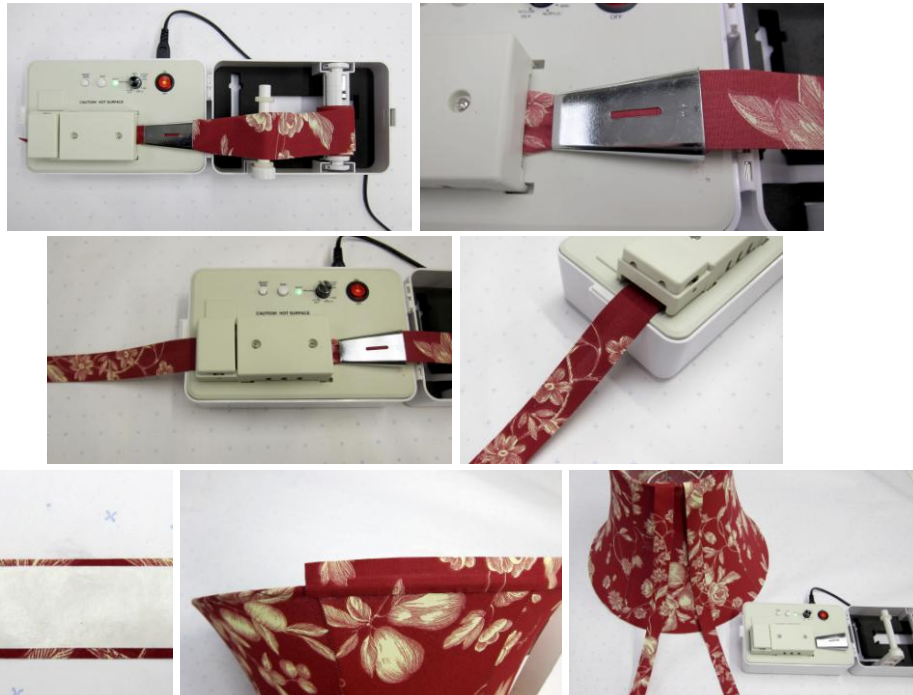

Cut your fabric into strips and feed into the Bias Tape Making Machine to create customized single fold bias tape with the push of a button.

Apply some double sided tape to the reverse and you have a matching finish for your lampshade.

[click here](#) for more details

Gimp 22mm wide

Traditional trimming wide enough to finish the shade inside and out.

Apply using double sided tape or EVA adhesive [click here](#) for more details

Matching tassels also available.



Tassel Fringe

Add a touch of elegance to your lampshades with a traditional tassel trim.

Easy to apply using a 12mm double sided tape or EVA adhesive.

[click here](#) for more details



Glass and Acrylic Beaded Trim

Add a touch of glamour to your lampshades with our beautiful glass and acrylic beaded trimmings. Beautifully hand crafted we stock a variety of shapes and colours.

[click here](#) for more details

